

Brake Master Cylinders

Girling Master Cylinders

Girling Aluminum Master Cylinders with Small (1.75" dia.) Integral Reservoir These reliable master cylinders feature a rear-facing outlet port that is ideal for cars with limited space in front of the cylinder. The outlet port has female 3/8-24 threads for easy connection to 3AN hose or 3/16" tubing. All sizes include a pushrod with a 5/16-24 thread. Pushrod length varies but is usually 3 to 4" long as measured from the mounting flange. See below for rebuild kits.

- Girling Master Cylinder with integral reservoir - 5/8" Bore* Part No. 3500-62 \$134.99
- Girling Master Cylinder with integral reservoir - .70" Bore* Part No. 3500-70 \$134.99
- Girling Master Cylinder with integral reservoir - 3/4" Bore* Part No. 3500-75 \$134.99
- Reservoir Extension for above master cylinders (with seal & cap)* Part No. 3560 \$47.99
When installing the extension, be sure to position the seal below the flange on the extension.
- Aluminum Cap for small (1.75" dia.) integral reservoir (without gasket)* Part No. 3549 \$17.99
- Plastic Cap for small (1.75" dia.) integral reservoir* Part No. 3550 \$14.99
- Aluminum Cap for large (2.5" dia.) integral reservoir (without gasket)* Part No. 3553 \$18.99
(We don't sell the large reservoir type of Girling Master Cylinder — just the caps.)

Girling Remote Master Cylinders without Reservoir Same as above but without an integral reservoir. A 7/16-20 female inlet port lets you connect to a remote reservoir, or you can screw a reservoir directly to the master cylinder. All sizes include a pushrod with a 5/16-24 thread. Pushrod length varies but is usually 3 to 4" long as measured from the mounting flange. See above for replacement pushrods and optional clevis. See below for rebuild kits and remote reservoirs.

- Girling Remote Reservoir Master Cylinder - 5/8" Bore (alum.)* Part No. 3502-62 \$124.99
- Girling Remote Reservoir Master Cylinder - .70" Bore (alum.)* Part No. 3502-70 \$124.99
- Girling Remote Reservoir Master Cylinder - 3/4" Bore (alum.)* Part No. 3502-75 \$124.99
- Banjo-Style Barbed inlet fitting for 5/16" I.D. hose, includes banjo bolt and washers* Part No. 3219 \$68.99
- Barbed inlet fitting for 5/16" I.D. hose, includes sealing washer* Part No. 3207 \$25.99
- 5/16" I.D. hose for connecting remote reservoirs, per foot* Part No. 3575-Foot \$2.99

Parts & Accessories for Girling Master Cylinders These parts fit both the Integral Reservoir and Remote Reservoir styles above.

- Girling Pushrod, 5/16-24 thread, 3.3 inch overall length* Part No. 3554-3.3 \$16.99
- Girling Pushrod, 5/16-24 thread, 3.7 inch overall length* Part No. 3554-3.7 \$21.99
- Girling Pushrod, 5/16-24 thread, 7.0 inch overall length* Part No. 3554-7.0 \$44.99
- Steel Clevis for pushrod, 5/16" hole, 5/16" slot, 1.8" overall length* Part No. 3576 \$17.99

Rebuild Kits for Girling Master Cylinders These kits fit both the Integral Reservoir and Remote Reservoir styles above. Note that these only work with genuine Girling master cylinders, not "Girling-style" copies.

- Rebuild Kit for Girling 5/8" Bore Master Cylinder* Part No. 3504-62 \$21.99
- Rebuild Kit for Girling 0.70" Bore Master Cylinder* Part No. 3504-70 \$22.99
- Rebuild Kit for Girling 3/4" Bore Master Cylinder* Part No. 3504-75 \$22.99
- Rebuild Kit for Girling 7/8" Bore Master Cylinder* Part No. 3504-87 \$33.99

AP / Lockheed Master Cylinder Rebuild Kits

Although the popular AP / Lockheed "Tin Can" style master cylinder is no longer made, we will continue to stock rebuild kits as long as they are available. Lockheed bore sizes are identified by the shape of the nose at the outlet of the master cylinder (see drawing below).

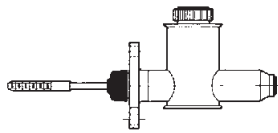

Rebuild Kit for Lockheed Master Cylinder, specify size Part No. 3514-Size \$27.99
Specify bore size when ordering: .62 (5/8"), .70, .75 (3/4"), or .87 (7/8").

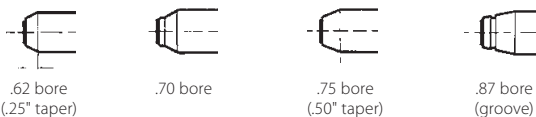

All of the master cylinders on this page have the standard vertical mounting flange with 2.25" hole spacing.

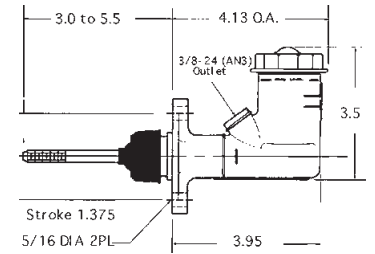

Girling Master Cylinder with Integral Reservoir Part No. 3500-Size

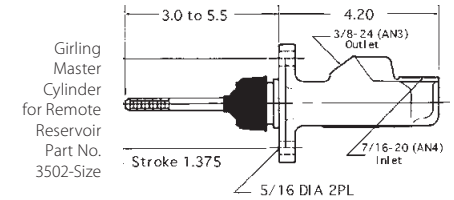

Identifying Girling Bore Sizes

Genuine Girling master cylinders have the bore size cast into the side of the cylinder (or the side of reservoir, on Integral Reservoir versions). It may be a fraction (5/8, 3/4) or a decimal (.625, .75). If it is hard to read with the master installed in the car, hold a piece of paper against the side and rub your finger over the paper. This will transfer the casting details onto the paper, making it more legible.

Brake Assembly Lube (Rubber Grease)



Brake Assembly Lube This special rubber grease is specifically recommended for use when rebuilding hydraulic brake or clutch components. Use it to lubricate rubber parts to prevent scuffing or tearing seals and to make assembly easier. Use it on master cylinder and caliper piston dust boots to help seal out water and ward off corrosion. Apply it generously when rebuilding spares to preserve rubber seals and to prevent them from drying out during storage. Compatible with all racing brake fluids. 2.7 ml packet is just enough to rebuild 1 or 2 calipers, or a set of 3 master cylinders.
Brake Assembly Grease, 2.7ml tube Part No. 3306-001 \$17.00

Remote Reservoirs

These reservoirs are for master cylinders that do not have an integral tank. All are translucent plastic for easy fluid level inspection. The Lockheed reservoirs below feature molded-in mounting tabs for easy installation on a firewall. Capacities shown are approximate.

- Lockheed Reservoir with Single 5/16" Push-on Fitting, 10 oz.* Part No. 3565 \$47.99
- Lockheed Reservoir with Dual 5/16" Push-on Fittings, 10 oz.* Part No. 3566 \$42.99
The dual outlet reservoir has an internal barrier to prevent a leak in one of the circuits from completely draining the reservoir.
- Replacement Cap for Part Nos. 3565 and 3566 (3.5" dia.)* Part No. 3570 \$19.99
- Replacement Cap Gasket for Part Nos. 3565 and 3566.* Part No. 3572 \$3.49
- 5/16" I.D. hose for connecting remote reservoirs (per foot)* Part No. 3575-Foot \$2.99
For all reservoirs with barbed push-on fittings. Withstands brake fluid better than standard fuel hose.

The Girling-style reservoirs below can be mounted directly on master cylinders with 7/16-20 female threaded ports. Note that some master cylinders may require shortening the male fitting to avoid interference at the bottom of the port.

- Girling-Style Single Reservoir with Offset 7/16-20 Male Fitting, 3.25" tall, 5 oz.* Part No. 3569 \$24.99
Offset allows 2.5" master cylinder spacing. Height is measured without fitting.
- Girling Single Reservoir with Centered 7/16-20 Male Fitting, 4.75" tall, 7 oz.* Part No. 3574 \$79.99
- Girling-Style Single Reservoir with Centered 7/16-20 Male Fitting, 9.5" tall, 12 oz.* Part No. 3569-002 \$34.99
Above reservoirs require 3" master cylinder spacing. Heights are measured without fitting.
- Replacement Cap for Part Nos. 3569 and 3569-002, 3" OD, 60mm threads* Part No. 3569-003 \$9.99
- Replacement Cap for Part No 3574 only, 3" OD, 2 3/8" threads.* Part No. 3573 \$23.99

The inlet fitting kits below will connect our 5/16" ID hose to any master cylinder with a 7/16-20 female inlet port.

- Barbed Inlet Fitting for 5/16" Hose, 7/16-20 Thread, with sealing washer* Part No. 3207 \$25.99
- Banjo Inlet Fitting Kit for 5/16" Hose, 7/16-20 Thread, with banjo bolt and washers* Part No. 3219 \$68.99

