

Weather Pack Sealed Electrical Connectors

The Weather Pack series of high-quality environmentally sealed automotive connectors is well proven in tough, long-term, real world street car applications. Self-lubricating silicone connector seals, cable seals, and cavity plugs exclude moisture, dust, dirt, and a variety of automotive chemicals to ensure a reliable electrical connection. Heat stabilized polyamide housings combined with the heat resistant silicone seals withstand the high temperatures and harsh conditions of a vehicle's engine compartment. With a positive snap latch and hinged, locking seal retainers, these connectors are immune to problems caused by extremely high shock and vibration environments.

- Available in 1, 2, 3, 4, and 6 terminal configurations.
- Rated to 16.0 volts and 20 Amps DC.
- Terminals available for 20 gauge to 10 gauge wire.
- Terminal seals available for wire insulation OD from 0.051" to 0.169".



Weather Pack Tower Connector Bodies Weather Pack connector bodies are not referred to as being male or female because you can use either male pins or female sockets in either half of the connector (or even mix pins and sockets in any combination). However, female terminals are usually used in these tower bodies.

- Single Pin Tower Connector Body* Part No. 4185-001 \$79¢
- Two Pin Tower Connector Body* Part No. 4185-002 79¢
- Three Pin Tower Connector Body* Part No. 4185-003 89¢
- Four Pin Tower Connector Body* Part No. 4185-004 99¢
- Six Pin Tower Connector Body* Part No. 4185-005 \$1.19

Weather Pack Shroud Connector Bodies Male pin terminals are usually used in these shroud bodies.

- Single Pin Shroud Connector Body* Part No. 4185-011 59¢
- Two Pin Shroud Connector Body* Part No. 4185-012 59¢
- Three Pin Shroud Connector Body* Part No. 4185-013 69¢
- Four Pin Shroud Connector Body* Part No. 4185-014 79¢
- Six Pin Shroud Connector Body* Part No. 4185-015 89¢

Weather Pack Terminals Male pin terminals are usually used in shroud bodies and female socket terminals are usually used in tower bodies. However, you can swap their position if desired. Spring tabs on either side of the terminal hold it firmly in place in the connector body.

- Male Pin Terminal for 20 to 18 gauge wire* Part No. 4185-030 24¢
- Male Pin Terminal for 16 to 14 gauge wire* Part No. 4185-031 29¢
- Male Pin Terminal for 12 to 10 gauge wire* Part No. 4185-032 32¢
- Female Socket Terminal for 20 to 18 gauge wire* Part No. 4185-040 24¢
- Female Socket Terminal for 16 to 14 gauge wire* Part No. 4185-041 29¢
- Female Socket Terminal for 12 to 10 gauge wire* Part No. 4185-042 32¢

Weather Pack Silicone Terminal Seals These seals not only exclude dirt and moisture, they also help to provide a strain relief for the wire. Note: The terminal insulation crimp must capture the terminal seal as shown in the photos below.

- Seal for 0.051 to 0.067" insulation dia., Red* Part No. 4185-070 23¢
- Seal for 0.062 to 0.085" insulation dia., Purple* Part No. 4185-071 15¢
- Seal for 0.080 to 0.112" insulation dia., Green* Part No. 4185-072 32¢
- Seal for 0.111 to 0.137" insulation dia., Grey* Part No. 4185-073 32¢
- Seal for 0.136 to 0.169" insulation dia., Blue* Part No. 4185-074 34¢

Weather Pack Silicone Cavity Plug Any unused pins in a Weather Pack body should be sealed with one of these cavity plugs. You can fill a connector body with cavity plugs to make a dust cap to seal disconnected Weather Pack connectors.

- Terminal Cavity Plug* Part No. 4185-090 34¢

Weather Pack Assortment Kit This 608-piece assortment includes 4 each of 2, 3, 4, and 6 pin tower and shroud bodies; 50 of each size male and female terminals; 50 of each size terminal seals; and 25 cavity plugs, all in a large plastic organizer box. A huge value!

- Weather Pack Assortment Kit, 608 Piece* Part No. 3029-001 .. \$152.99

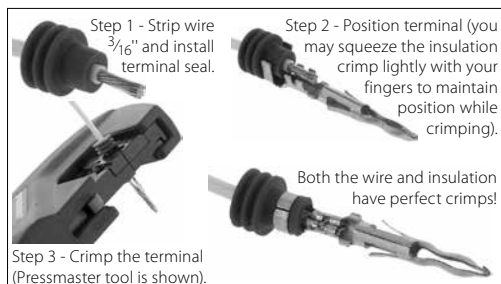

608-Piece Weather Pack Assortment Kit Part No. 3029-001



You can make your own dust cap by filling a connector body with cavity plugs.



Weather Pack Tools

Using the proper tools helps to ensure a reliable electrical connection and makes assembling your Weather Pack connectors quick and easy.

Weather Pack Terminal Extraction Tool



Use this handy tool to compress the locking tabs on either male pin terminals or female socket terminals to remove a wire and terminal from a connector body without damage.

- Terminal Extraction Tool* Part No. 4185-093 .. \$10.99

Pressmaster Crimp Tool Frame and Dies



Weather Pack Die Set Part No. 4185-095



The **Pressmaster** crimping system uses a universal squeezer frame that accepts a variety of die sets (sold separately) for crimping a wide variety of terminals. A ratcheting function ensures that every crimp is complete and uniform. The **Weather Pack die set** crimps both the wire and insulation in a single operation!

- Pressmaster Ratcheting Squeezer* ... Part No. 4185-094 .. \$84.99
- Weather Pack Die Set, 20 to 12 ga.* ... Part No. 4185-095 .. \$169.99

Other Pressmaster Die Sets The Pressmaster crimping frame can accept a number of interchangeable dies to handle different types of electrical terminals.

- Die Set for Insulated Terminals* Part No. 4185-096 .. \$53.99
For 22-14 gauge insulated terminals (red and blue terminals).
- Die Set for Non-insulated Terminals*. Part No. 4185-097 .. \$53.99
For 22-10 gauge non-insulated terminals and splices.
- Die Set for Insulated Terminals* Part No. 4185-098 .. \$61.99
For 26-22 and 12-10 gauge insulated terminals and splices.

Other Weather Pack Crimping Tools



Weather Pack Pro Crimping Tool Part No. 4185-099



Weather Pack Dual Action Tool Part No. 4185-150

These economical tools will crimp most sizes of Weather Pack terminals and cable seals. The **Pro Tool** requires two separate operations to crimp the terminal and the seal. Many professionals prefer the extra level of control this allows. The **Dual Action Tool** crimps both terminal and seal in one single operation. Both tools have a ratcheting function to ensure consistent, uniform crimps. For 20-14 gauge terminals.

- Weather Pack Pro Crimping Tool* Part No. 4185-099 .. \$139.99
- Weather Pack Dual Action Tool* Part No. 4185-150 .. \$119.99

Fuse Blocks for ATC Blade Type Fuses

These compact fuse panels are a great way to organize your wiring. They use standard ATC blade type fuses (not included) that are available at any auto parts store. The 10-32 input stud is rated for 150 amps. Each individual fuse position is rated for 30 amps. The output terminals are standard male push-on spades and accept standard female push-on terminals. We recommend using fully insulated terminals to avoid accidental shorts when working near the fuse block (our Part No. 4110, 4123 or 4135). Each fuse block has 4 recessed mounting holes that will accept a 10-32 mounting screw. The black thermoplastic housing is UL rated 94VO for flame resistance. The recommended temperature range is from -20 to 150°F.

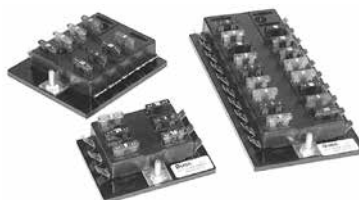

We stock these fuse blocks in 6, 10 and 20 circuit configurations. All are 3.37" wide. The lengths are given below. **Hint:** Choose a size that will leave a few spare circuits available for future additions to your electrical system.

- 6 position fuse block, 2.47" long*
Part No. 4402-06 \$16.79
- 10 position fuse block, 3.72" long*
Part No. 4402-10 \$20.49
- 20 position fuse block, 6.87" long*
Part No. 4402-20 \$34.49