

Brake Calipers

Performance Friction ZR55 F2000 Calipers



The **Performance Friction ZR55 Caliper** is a modern aluminum 2-piston caliper. It weighs just 3.5 pounds, more than 3 pounds lighter than an LD 20 caliper. Special piston insulators help to reduce fluid boiling. Radial mounting fits 2010 and newer Van Diemen and Citation uprights. Sold individually. Each caliper includes a 3AN adapter, banjo adapter, and banjo bolt to fit the M10 inlet.

PFC ZR55 Caliper, Front (trailing mount), Left Part No. 3552-503 \$899.00
PFC ZR55 Caliper, Front (trailing mount), Right ... Part No. 3552-504 \$899.00
 "Front" calipers have 44mm pistons and are designed for a trailing mount.

PFC ZR55 Caliper, Rear (leading mount), Left Part No. 3552-501 \$899.00
PFC ZR55 Caliper, Rear (leading mount), Right ... Part No. 3552-502 \$899.00
 "Rear" calipers have 41mm pistons and are designed for a leading mount.

Piston Seals for Front Calipers (44mm), set of 4 ... Part No. 3552-528 \$50.99
Piston Seals for Rear Calipers (41mm), set of 4 Part No. 3552-527 \$29.99

Wilwood PL2R/ST Calipers



The **Wilwood PL2R/ST** is a club-racing alternative to the ZR55 calipers at left. If you are not racing in the Pro FF2000 series, you can still enjoy state-of-the-art braking without breaking the bank. These are SCCA-legal, bolt-on replacements for the ZR55. Internal fluid passages eliminate the vulnerable crossover tubes on the ZR55 design. 1.75" diameter pistons.

Wilwood Powerlite 2 Caliper, Right (trailing) Part No. WW120-13863-N \$304.99
Wilwood Powerlite 2 Caliper, Left (trailing) Part No. WW120-13864-N \$304.99

Replacement 1.75" Piston Seal, each Part No. WW210-4840 \$2.99
 These seals fit Wilwood calipers only.

Alcon R-Type Formula Ford Caliper

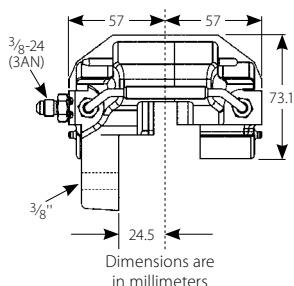

SCCA legal for FC, FF, and S2000.

The popular **Alcon R-Type Caliper** is a proven winner, with years of success in many different types of racing. This lightweight 2-piston aluminum caliper weighs less than 3 pounds. That's less than half the weight of the original cast iron LD 20! The leg-mount design is a direct bolt-on replacement for the LD 20 caliper. No adapting, machining, or modifications are required. The 1.75" piston diameter is the same as the LD 20, so your brake bias setup won't change either. The R-Type uses a common D44 pad shape, which is available in many different compounds from most brake pad manufacturers. We stock Hawk Brake (HB118) and Performance Friction (PF044) pads for this caliper.

Alcon R-Type Caliper, Left (trailing mount) Part No. 3599-001-RL/LT ... \$449.99
Alcon R-Type Caliper, Right (trailing mount) Part No. 3599-001-LL/RT ... \$449.99
 Left and Right assume a trailing-mount installation (mounted on the back side of the upright). Order the opposite side for a leading-mount application.

Replacement 1.75" Piston Seal, each Part No. 3599-020 \$17.99
 These seals fit the Alcon R-Type caliper only.

Wilwood WLD20 Caliper for FF1600 / FF2000



The **Wilwood WLD20** is a modern aluminum replacement for the old AP "LD 20" caliper (CP2577) which was discontinued by AP several years ago. This 2-piston caliper is designed to be a bolt-on replacement, with no machining or adapting required. It retains the same 3/8" - 24 inlet thread size and 1.75" diameter pistons as the original too. You won't even need to make any adjustments to your setup! The WLD20 even takes the same LD 20 pad shape as the original AP caliper, so your spares won't go to waste. Lightweight forged aluminum construction weighs about one-third of the original (2.3 lb vs 6.8 lb) and is SCCA legal for all formula car and sports racer classes. Unlike the original, the WLD20 uses corrosion-resistant and thermally-insulating stainless steel pistons. These new calipers also fit either right or left side, which means half as many spares in the trailer.

Wilwood WLD20 Aluminum Caliper Part No. WW120-14375 \$199.99
Wilwood 1.75" Caliper Seal, each Part No. WW210-4840 \$2.99
 These seals fit Wilwood calipers only.

MSE Gem LD 19 Caliper for FF1600

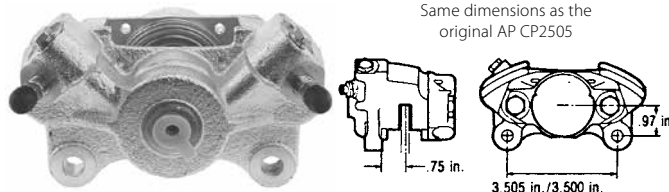

Brand-new LD 19 calipers — not rebuilt, remanufactured, or NOS!

MSE Gem LD 19 Caliper Developed and tested extensively by a leading racing school in the UK, the Gem is a direct replacement for the old AP "LD 19" caliper (CP2505) which was discontinued by AP several years ago. This high-quality reproduction has been carefully crafted to be an absolutely painless, no-fuss replacement. It is the same as the original in every dimension, including the 1.625" piston size and 3/8" - 24 inlet port threads. The Gem uses the same LD 19 pad type as the original AP caliper, so your spares won't go to waste. Cast iron construction is legal for all FF1600 classes, including vintage racing where aluminum calipers may not be allowed. Just as on the original, each caliper can be used on either the left or right side.

MSE Gem LD 19 Caliper Part No. 3599-200 \$189.99
 Brand-new caliper, not rebuilt or remanufactured. Built specifically for racing use.

MSE Rebuild Kit for Gem LD 19, 1.625" Part No. 3599-201 \$24.99
 Piston seals, dust seals, and dust seal retainers for 1 caliper. Also fits the AP CP2505 caliper.

AP / Lockheed Caliper Repair Parts

These seals fit AP Racing seal-in-bore calipers (the seal fits into a groove in the caliper bore). They do not fit seal-on-piston (sliding seal) calipers.

AP Racing Piston Seal, each Part No. 3580-Size \$16.99
 Specify piston size: 1 3/8", 1 1/2", 1 5/8" (LD 19), 1 3/4" (LD 20), 2 1/8", or 36mm/1.42" (LD 65).

Note: Piston seals will only fit tight against the piston after installation in the bore. They will be a loose fit prior to installation. This applies to all brands.

AP / Lockheed Cross Feed Seal (each) Part No. 3596 \$9.99
 Measures 0.500 OD x 0.110 thick. **Note:** AP recommends against splitting calipers.

Piston for LD 19 Caliper, 1.625" diameter, each ... Part No. 3582-1.625 \$39.99
Piston for LD 20 Caliper, 1.75" diameter, each Part No. 3582-1.75 \$52.99

The stainless steel pistons below are not made by AP / Lockheed. They are precision-made in the USA from type 304 stainless steel and polished to a sub-20 micron finish.

Stainless Steel LD 19 Piston (1.625"), ea. 3579-Stainless-LD19 \$39.99
Stainless Steel LD 20 Piston (1.75"), ea. 3579-Stainless-LD20 \$39.99
Stainless Steel LD 65 Piston (36mm), ea. 3579-Stainless-LD65 \$39.99

Girling Caliper Repair Parts

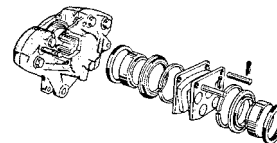

Although we do not carry Girling calipers, we do offer rebuild kits for certain Girling calipers commonly used on Formula Fords. The larger **14LF** Caliper has 1.89" diameter pistons and 4 bolts holding the caliper halves together. The smaller **12SP** (more common on vintage cars) has 1.69" pistons and only 2 bolts holding the caliper together.

Rebuild Kit for two Girling 14LF calipers Part No. 3590 \$27.99
Rebuild Kit for one Girling 12SP caliper Part No. 3552-001 \$17.99

Piston for 14LF caliper, 1.89" dia., each Part No. 3591 \$34.99
Cross Feed Seal for Girling Calipers (1 seal) Part No. 3595 \$4.99
 Measures 0.480 OD x 0.075 thick. **Note:** Girling recommends against splitting calipers.